

split precision

With luxury in mind, a couple's master bath on Martha's Vineyard draws a clear line between his and hers.

written by CHRIS HAYHURST *photographer* MICHAEL PARTENIO *field editor* STACY KUNSTEL

OPPOSITE: The polished-chrome tub fixtures feature cross handles reminiscent of earlier days. The classic look helps disguise the tub's modern whirlpool jets. **THIS PHOTO:** His space meets hers at the walk-through shower. Like the tub deck and vanity tops, the shower features a soft shade of travertine.





the bath built for two is a tried-and-true design concept. Here, however, spreading across the spacious master suite of a harborside home on Martha's Vineyard, is an approach that goes beyond mere sharing. It's almost two separate baths, connected by a shower that doubles as a breezeway.

"They each have their own space," architect Patrick Ahearn says of the husband-and-wife homeowners. "And each space was built to fit their needs." Because the wife likes to bathe and the husband prefers to shower, the soaking tub is in her space. So are the makeup nook and a bank of walk-in closets. His side includes a breakfast counter and a vanity. Both areas feature views of the water.

Though each side of the bath can be accessed separately from an adjacent hall that is part of the master suite, the simplest path from his space to hers is through the glass-door shower. "The shower really ties the two rooms together," Ahearn says. "It's a place for them to meet in the middle. Or, if they leave the doors open, the acoustics work

really well, so while he's shaving and she's getting dressed, they can talk to each other even though they're in separate spaces."

That sense of communication—or, as Ahearn puts it, "circulation"—is enhanced through consistent materials. The beaded board on the walls, for instance, is in the same custom shade of white found throughout the home. The entire floor is oak. All countertops are cream-color travertine. Cabinets, mirrors, and lighting are identical in both spaces. "The finishes are island-appropriate," Ahearn says, "but with the stone, moldings, art, and light fixtures, the overall effect is a little more upscale and formal. It's a warm and furnished space, not just a utilitarian one."

In this his-and-her bath, Ahearn notes, routines are meant to unfold slowly. It's a summer home, an island home, and so the typical day is long and sweet. "We designed it as a place for them to linger," he says. "To enjoy the morning sun, to relax and drink coffee, to take their time as the day begins." **KOB**

RESOURCES BEGIN ON PAGE 134.

Creamy colors, cozy furnishings, and a coffee bar give this elegant and soothing bath a take-your-time vibe.

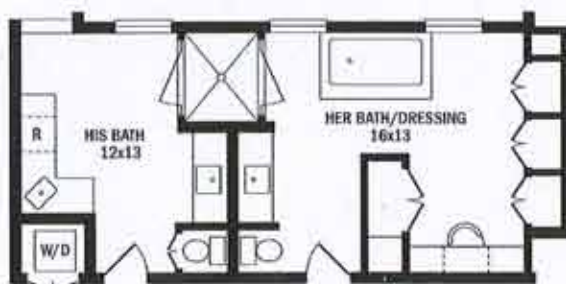

OPPOSITE: Both rooms include views of the water through light-filtering plantation shutters. Abundant texture in the moldings and beaded board and the lightly stained oak floor create warmth. **ABOVE:** Smooth travertine countertops balance the detailed walls and moldings. The casing around the mirror creates a timeless, built-in look. **ABOVE RIGHT:** A dedicated makeup station offers a leisurely spot to get ready in the morning and enjoy a cup of coffee.

TAKEAWAYS

- 1 A walk-through shower creates a physical and visual connection between the couple's separate areas.
- 2 Beaded-board walls and richly detailed moldings add texture.
- 3 Hardwood floors and soft colors generate a sense of warmth.